

Papercraft - Printing Preferences

One-Sided

This page is about printing preferences of downloaded the PDF template files. Please prepare a home A4 printer.

* Printing preferences may vary depending on a manufacturer of a printer.

* Colors of printouts may vary depending on a printer, ink, and media type.

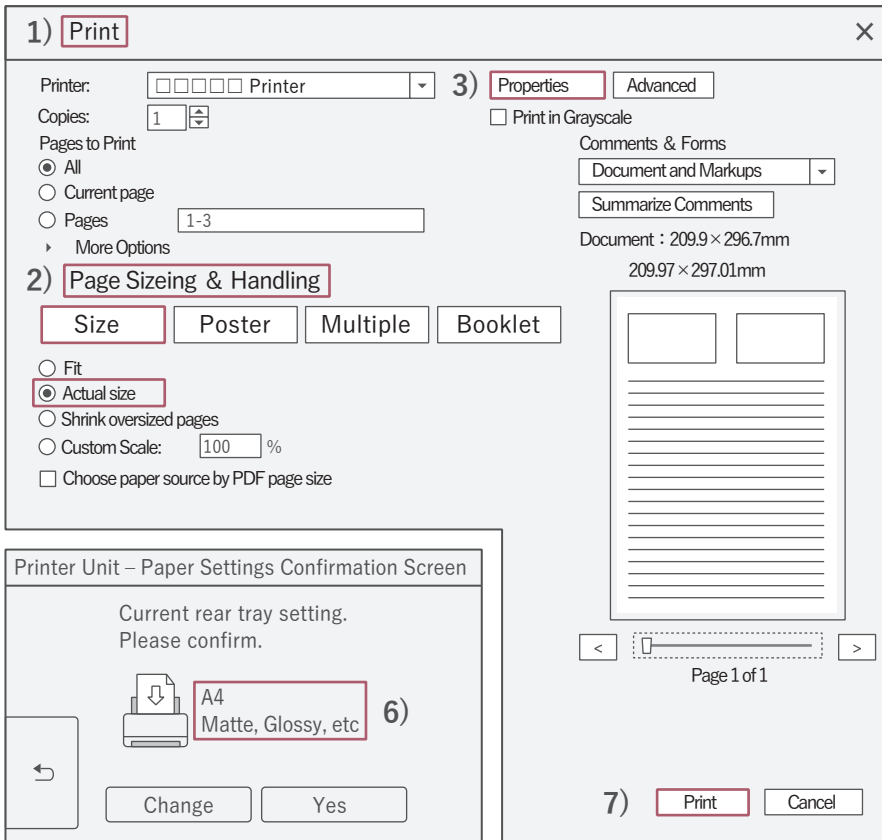

■ Acrobat Reader Print Window

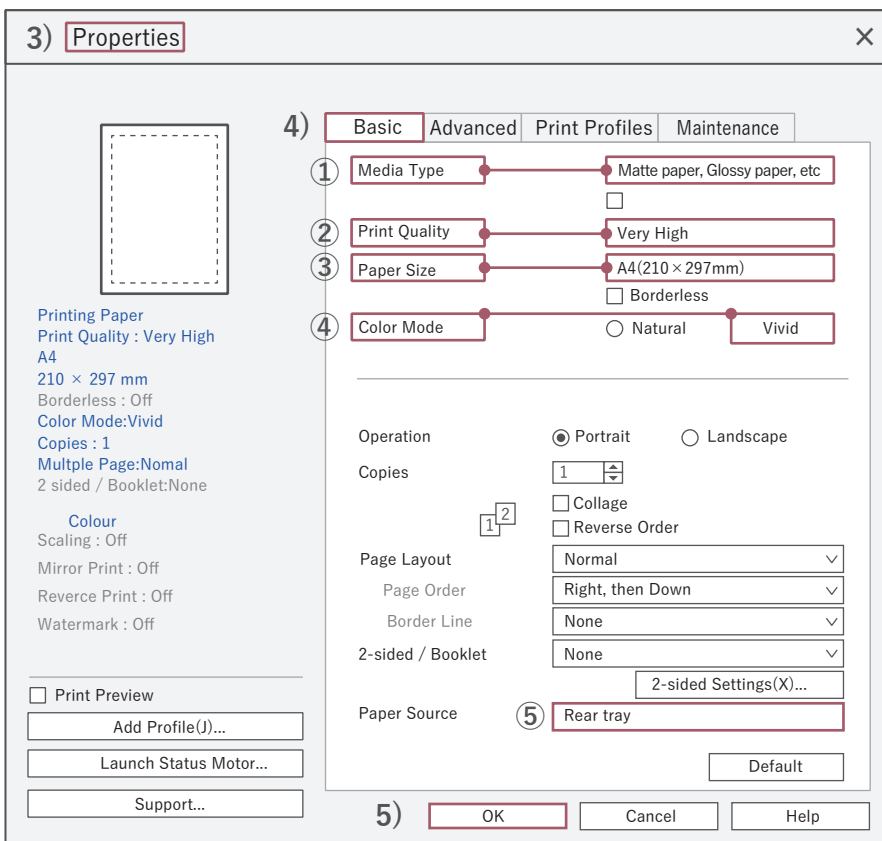

■ Acrobat Reader Properties Window

□ Printing Process | One-Sided

- 1) Open the print window.
- 2) Under Page Sizing & Handling, select Actual size.
- 3) Click Properties in the upper-right corner of the print window.
- 4) In the Properties window, select the Basic tab and configure the settings according to your printing paper:
 - ① Media Type: Matte Paper, Glossy Paper, etc.
 - ② Print Quality: Very High
 - ③ Paper Size: A4
 - ④ Color Mode: Vivid
 - ⑤ Paper Source: Rear tray
- 5) After completing the settings, click OK.
- 6) On the printer itself, set the paper type to match the selection made in step 4-①. For example, when using Canon printers with matte or glossy paper, select High Resolution Paper. For other paper types, refer to the information printed on the back of the paper package.
- 7) Make sure the paper is loaded in the rear tray, then click Print to finish.

Papercraft - Printing Preferences Double-Sided

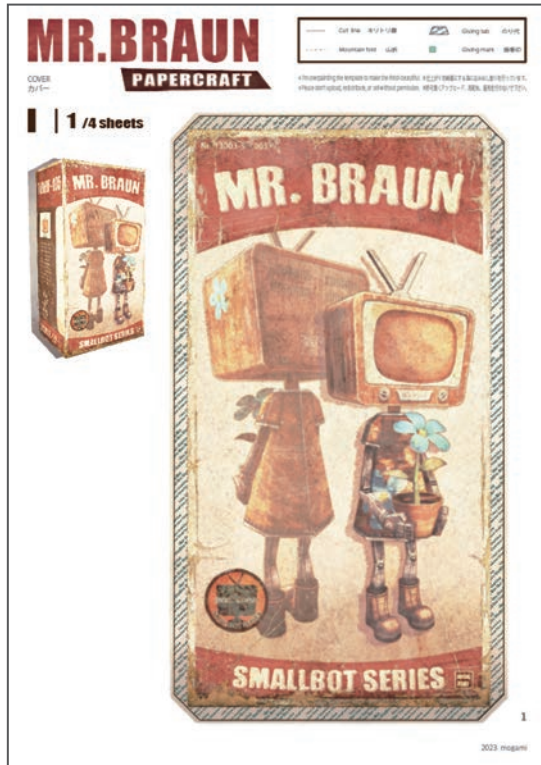

Front-Side (Side I)



Back-Side (Side I')

■ Two sheets marked with the same Latin letter



Front-Side Printing

Horizontal Flip

Rotate the sheet 180° and print the back side.

■ Process Diagram for Double-Sided Printing

□ Printing Process - Double-Sided

- 1) Sheet Preparation : Prepare the data for two sheets marked with the same Latin letter (e.g., Side I and Side I').
- 2) Front-Side Printing : Load the paper into the rear tray with the front side (coated side: the white side suitable for printing) facing up, and print. Make sure the paper is properly aligned to prevent shifting.
- 3) Horizontal Flip : Flip the paper horizontally for back-side printing.
- 4) Back-Side Printing : Rotate the paper 180° and print the back side. As with the front side, make sure the paper is properly aligned to prevent shifting.